



Eco-Sophia Symposium 2011

— 8th International Whitehead Conference —

Creativity and Harmony:
The Way of Eco-Sophia for the Future of Civilization

Program

September 26-29, 2011

The Yotsuya Campus, Sophia University, Tokyo, Japan

Eco-Sophia Symposium 2011 —8th International Whitehead Conference —

Schedule and Program

25th September, Sunday

- 15:45- **Registration (Auditorium Lobby, Building 10)**
18:00-19:30 **Coffee Reception by SSCM (Sophia Sustainable Coffee Movement)**
 (B-Lounge, Building 11)

26th September, Monday

- 9:00- **Registration**

- 10:00-11:30 **Opening Session (Auditorium, Building 10)**

Chair: SUZUKI Nobukuni

Opening Ceremony: Sophia University Glee Club
Prayer: Jean-Claude HOLLERICH SJ (Archbishop of Luxemburg)
Congratulatory Address: TAKIZAWA Tadashi (President of Sophia University)
Welcome Address: TANAKA Yutaka (Director of Eco-Sophia Symposium 2011)
Invited Lecture: TAKEDA Ryusei (Professor Emeritus of Ryukoku University)
Birth, Aging, Sickness, and Death in the Nuclear Age

- 11:30-13:00 Lunch Time (PC Room is available 11:00-14:00, Room310, 3rd Floor, Building 2)

- 13:00-15:30 **Plenary Session: Symposium 1 (Auditorium, Building 10)**

Process Ecozoics: Philosophy and Theology in the Ecozoic Age

Chair: TANAKA Yutaka, John T. BRINKMAN

NOBUHARA Tokiyuki
The Problem of the Two Ultimates and the Proposal of an Ecozoics of the Deity: In Dialogue with Thomas Berry, Sallie McFague, Anselm, Aquinas, Whitehead, and Nishida.
Jai-Don LEE
Thomas Berry's New Cosmology and the Ecozoic Era
Herman GREENE
Process Ecozoics: Philosophy and Theology in the Ecozoic Age

26th September, Monday

15:45-18:15 **Plenary session: Symposium 2 (Auditorium, Building 10)**

The Sense of Peace: Process Philosophy and Eastern Thoughts

Chair: TANAKA Yutaka, ISHIDA Masato

ENDO Hiroshi
Whitehead's Theory of the Sense of Peace – What occurs on the edge of consciousness? –
Kurian KACHAPPILLY
"Holocoenotic" view of Ecology - An Indian Process Model-
Steve ODIN
Whitehead's Perspectivism as a Basis for Environmental Ethics & Aesthetics: A Process View on the Japanese Concept of Nature

19:00-20:15 Prayer for Sufferers of the Great East Japan Earthquake

(Ignatius Church 2F, Our Lady's Chapel)

Gregorian Chant by St. Gregory's House Choir

27th September, Tuesday

9:00-11:30 **Parallel Session**

Each speaker of one parallel session has 45 minutes for his/her presentation and discussion.

Room 1 (Building 3-123-1F)	Room 2 (Building 3-124-1F)	Room 3 (Building 3-171-1F)
Chair: MURATA Yasuto Brian HENNING	Chair: NAGAO Shiro FAN Meijun	Chair: ARAKAWA Yoshihiro Cyril VELIATH
UMEDA Kota	LUO Xiaoping	YAMAURA Yuzo
A Philosophical Analysis of "Eco"-under the guidance of Hanna Arendt's <i>Human Condition</i>	On Process View : Momentum of Ecological Society's Development	Philosophical methods and ways in Whitehead and Kant
ABE Yoshihiko	LIU Qihua	MORINAGA Naomiki
Sapientia convivendi in Life of Suso-Narratological Perspective of German Mysticism on the Horizon of Love and Reconciliation	A Preliminary Research on the Developing Model of Technological Sciences-Besides Discussion on a social mechanism of Modern Science & Technology Policy	Subject and Reflexivity: Bergson, Whitehead and Benjamin
WANG Shizhong		WEN Hengfu & YANG Li
Analysis on influence of ecological factors on China's primary schools' and secondary schools' layout restructuring in minority areas		The 85-year research on Whitehead's Philosophy of Organism in China

11:30-13:00 Lunch Time (Building2, 5 F Cafeteria)

PC Room is available 11:00-14:00 (Room310, 3rd Floor, Building 2)

27th September, Tuesday

13:00-15:30 **Parallel Session**

Each speaker of one parallel session has 45 minutes for his/her presentation and discussion.

Room 1 (Building 3-123-1F) Chair: MURATA Yasuto	Room 2 (Building 3-124-1F) Chair: NAGAO Shiro FAN Meijun
WANG Zhihong	HIROSE Chuichiro
The evolution of "otherness" and the presentation of "inclusion" under the view of Western intellectual history	Toward a sustainable global society-holistic transformation of civilization through adventure of ideas and practices
WANG Tianen	Leslie MURAY
Ecological Systemic Process and the Ways of Human Thinking and Acting	Citizenship in an Ecological Civilization
HIRATA Ichiro	ZHAO Jianjun
Final Cause of Whitehead's <i>Process and Reality</i>	The analysis of China Green Development Model

13:00-15:30 **Parallel Session**

Each speaker of one parallel session has 45 minutes for his/her presentation and discussion.

Room 3 (Building 3-171-1F) Chair: ARAKAWA Yoshihiro Cyril VELIATH	Room 4 (Building 4-184-1F) Chair: ITOW Shigeyuki Robert SMID
Egor MAKHAROV	John T. BRINKMAN
Foundations of Dialogue among Cultures	Harmony, Attribute of the Sacred and Phenomenal
Kurian KACHAPPILLY	ZHANG Zailin
Community-An Example of 'Organic Extensive Society'	The Great Change of the Human Philosophical Ideas Expedited by "Japan' Disaster"
OZAKI Makoto	WANG Zhihe
History and Eternity from Tanabe's Perspectives	The Second Enlightenment and a Postmodern Green Lifestyle

27th September, Tuesday

15:45-18:15 Parallel Session

Each speaker of one parallel session has 45 minutes for his/her presentation and discussion.

Room 1 (Building 3-123-1F) Chair: MURATA Yasuto	Room 2 (Building 3-124-1F) Chair: NAGAO Shiro	Room 3 (Building 3-171-1F) Chair: ARAKAWA Yoshihiro
HIRATA Ichiro	Donna BOWMAN	Helmut MAASSEN
Continuity and Atomicity	Needle, Hook, Relational Wisdom: The Prayer Shawl Ministry As Creative Engagement With Fate	Identity and Religious Conflicts
Heine SIEBRAND	WU Libing	KIM Hiheon
The ground beneath our feet	The Ecological Civilization on basis of Marxism Philosophy	A Korean Panentheism: Ham Seok-heon's Thought for Future Civilization
YUAN Zushe	WU Xueqin	Alexander HAITOS
The Theory of human dignity of Marxism and its practice in contemporary China	Tries to Analyze the Possibility of Realizing Ecological Civilization	Foreseeing novelty: Bergson and Whitehead on Possibility and Creation

18:30-20:30 IPN Board Meeting Room 4 (Building 4- 184-1F)

28th September, Wednesday

9:00-11:30 Parallel Session

Room 1 (Building 3-123-1F) Chair: OZAKI Makoto	Room 2 (Building 3-124-1F) Chair: HONGO Hitoshi, WANG Zhihe	Room 3 (Building 3-171-1F) Chair: SAKAI Tugiko Leslie MURAY
TSUDA Yoshio	HAO Dong	SATO Yosuke
The essence of today's "ECO" movement and its twofold dangers-with Heidegger's criticism of technology	Low-Carbon Technological Paradigm in Urbanization of China	The ground as nothingness
SHIRAI Masato	ZHU Chengke	LI Hengwei
Toward Being for Others, with Others-Suggestions from Kitaro Nishida's "I and Thou"-	From Process to Generation: Transformation and Establishment of Contemporary Educational View	Contrast and comparison between Xiong Shili's and Alfred North Whitehead's metaphysics and cosmology
FAN Meijun	ISHIDA Masato	YANG Fubin
Ecological wisdom in Daoism	The Environment Regarded as Symbolic Space: Expanding upon Whitehead's Symbolic Reference	How to Keep A Harmonious Relation to Nature: from the Perspective of Whiteheadian Viewpoint of Organist Cosmology

28th September, Wednesday

11:30-13:00 Lunch Time (Building2, 5 F Cafeteria)

PC Room is available 11:00-14:00 (Room310, 3rd Floor, Building 2)

13:00-15:30 Parallel Sessions

Each speaker of one parallel session has 45 minutes for his/her presentation and discussion.

Room 1 (Building3, 123, 1F) Chair: OZAKI Makoto Helmut MAASSEN	Room 2 (Building 3-124-1F) Chair: ISHIDA Masato Maria Teresa TEIXEIRA	Room3 (Building 3-171-1F) Chair: SAKAI Tugiko Steve ODIN
LI Fang	ITOW Shigeyuki	HANAOKA Eiko
The Idea of Process Education in Whitehead's Philosophy of Organism	A.N.Whitehead and Ervin Laszlo: A New Global Philosophy of Systems	Eco-sophia in “the Wisdom as prajuna viz. Love as agape” - through the change of paradigms-
PARK Iljoon	LI Sen	JANG Wang Shik
To Talk about Justice: Suturing the Whiteheadian harmonious subject to the Badiouan militant subject for the universal subject of <i>ta me onta</i> - A Badiouan Response to <i>Event and Decision</i>	Eco-class: Harmonium and Creation	A Whiteheadian Evaluation of East Asian Aesthetic Philosophy
Mirosław PATALON	John QUIRING	Brian G. HENNING
Religious Education in Poland and the New Paradigms in Ecology	Collapse or Sustainability? Future-Ethics, Eco-Pluralism, and Process Thought	The Ontology of Collective Individuals and the Process Turn

15:45-18:15 Plenary Session: Symposium 3 (Auditorium, Building 10)

The Future of Civilization: Japan and the world after 3/11

Chair : TANAKA Yutaka, Herman GREENE

MIYAMOTO Hisao
Fire of Prometheus or Fire of Spirit
YAMAWAKI Naoshi
The Future of Civilization from a Perspective of Glocal Public Philosophy
YAMAMOTO Ryoichi
Intergovernmental Ethics Panel for Ecological Civilization

28th September, Wednesday

18:30-20:30 Banquet (Building11, Basement, Dining Lounge)

Congratulatory Address

KOSO Toshiaki (Chancellor of Sophia School Corporation)

Awards Ceremony

Dance Performance

KUZE Ryugoro 久世 龍五郎 (Dance, 舞) / Anri アンリ (Accordion, アコーディオン)

Program (演目) : 『bridge』

久世 龍五郎 (KUZE Ryugoro) and circustik orchestra (<http://circustik.web.fc2.com/>)

29th September, Thursday

9:00-11:30 Parallel Session

Each speaker of one parallel session has 45 minutes for his/her presentation and discussion.

Room 1 (Building 3-123-1F) Chair: HAMAZAKI Yoko	Room 2 (Building 3-124-1F) Chair: HIROSE Chuichiro, WANG Zhihe	Room 3 (Building 3-171-1F) Chair: HIRATA Ichiro John T. BRINKMAN
ANZAI Masahiro	IHARA Seiji	YOSHIDA Koji
The reflect of the war-liking of logos-centrism- The way to co-exist and reconcile-	A. N. Whitehead and Business: What to learn from him	The Significance of Whitehead's Philosophy of Organism: Its Novelty and Universality
IIMORI Motoaki	CHEN Aihua	YUAN Duo
Reason and the Other - Whitehead's reason which adventures and Levinas's Skepticism as Revenant	Environmental Moral Philosophical Review on the Logic of "City Charm"	The Significance of Whitehead's Educational Philosophy in the Reform of China's Higher Education
Robert SMID	YANG Xiao-ming & GAO Ce	Maria Teresa TEIXEIRA
Effective Catalysts for Large-scale Social Change: An Argument from Process Philosophy and Chinese Confucianism	Study on Lightning-Proof Mechanism in Buildings via Naturism Concept in Ancient China	We are in the World and the World is in us

11:30-13:00 Lunch Time (Building2, 5F Cafeteria)

PC Room is available 11:00-14:00 (Room310, 3rd Floor, Building 2)

29th September, Thursday

13:00-14:20 Closing Session (Auditorium, Building 10)

Chair: SUZUKI Nobukuni, SARODO Shigeki (Sophia University)

Closing Address:

TANAKA Yutaka (Director of the Organizing Committee)

WANG Zhihe (China) Chinese delegations and China Project

Helmut MAASSEN (Germany) IPN and Whitehead in Germany

Mirosław PATALON (Poland) WMS and the next IWC in Poland

Congratulatory Address

Angela YIU (Vice-President of Sophia University)

accompanied with Sophia University Choir

14:40-15:30 IPN General Meeting (Auditorium, Building 10)

Chair: Helmut MAASSEN, Herman GREENE

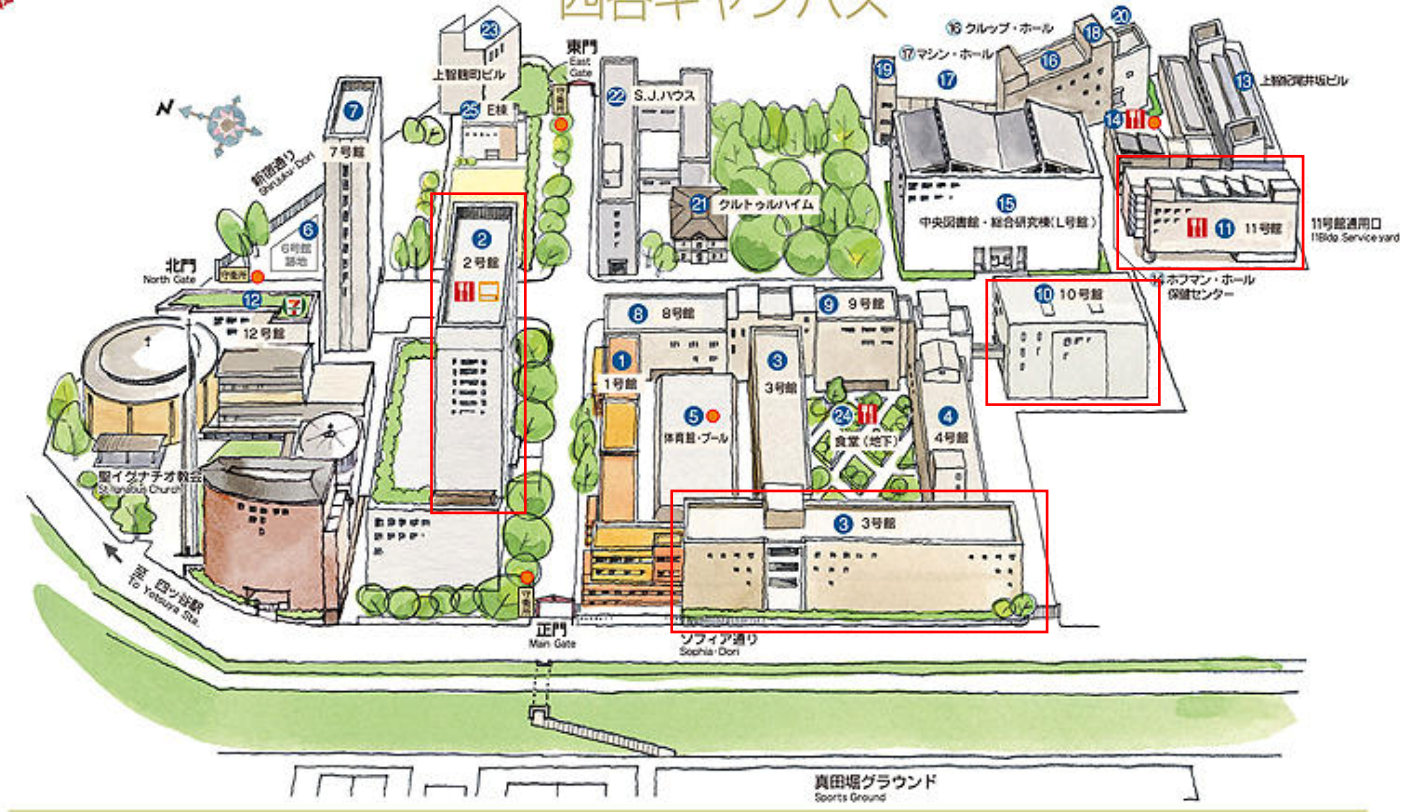

No		No	
1	Bldg. No.	13	Jochi Kioizaka Bldg.
2	Bldg. No. 2 Lunch (5F) PC & Copy Room (3F)	14	Hoffmann Hall
3	Bldg. No. 3 Conference Rooms for Parallel Sessions (1F)	15	Central Library and Research Institutes
4	Bldg. No. 4 Information Desk (1F)	16	Krupp Hall
5	Gymnasium / swimming pool	17	Machine Hall
6	Bldg. No. 6	18	Power Station 1
7	Bldg. No. 7	19	Power Station 2
8	Bldg. No. 8	20	Power Station 3
9	Bldg. No. 9	21	Kulturheim
10	Bldg. No. 10 Auditorium: Information Desk Opening , Closing, and Plenary Sessions	22	S. J. House
11	Bldg. No. 11 Banquet Lounge (Basement)	23	Jochi Kojimachi Building
12	Bldg. No. 12	24	Cafeteria(basement)

1・3・4・8・9号館



Conference Rooms for Parallel Sessions
(Bldg. 3, 1st Floor)



Information Desk
(Bldg. 4, 1st Floor)

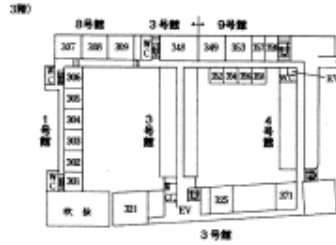

2号館

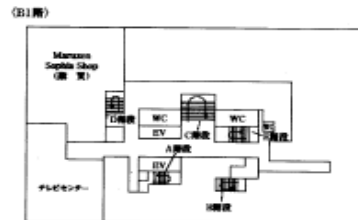
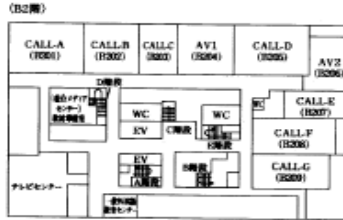

Ginza Suehiro
[Cafeteria]
(Bldg. 2, 5th Floor)

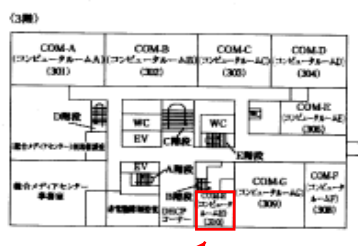
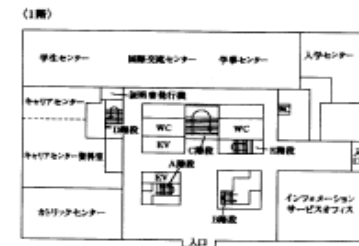

PC Room
(11:00-14:00)
Bldg. 2, 3rd Floor)

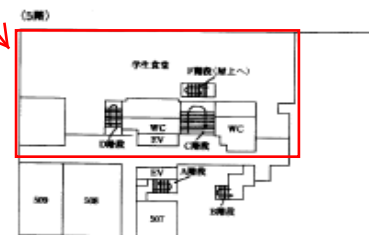

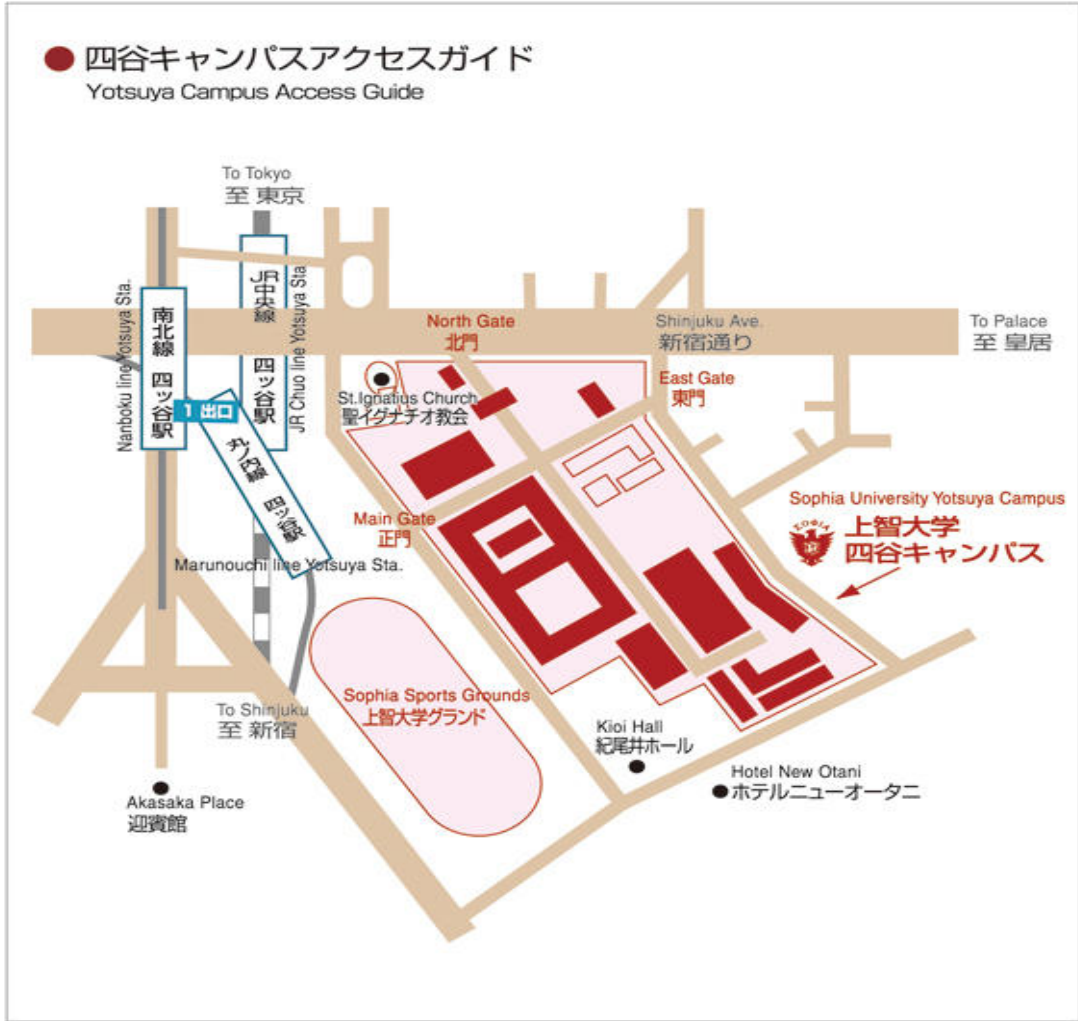

Our Lady's Chapel (2nd Floor)

カトリック麹町 聖イグナチオ教会

〒102-0083 東京都千代田区麹町 6-5-1

Tel. 03-3263-4584 Fax. 03-3263-4585

URL. <http://www.ignatius.gr.jp>

I-Mode <http://www.ignatius.gr.jp/i/>

教会内案内マップ Church Information map



Lunch on Campus

Ginza Suehiro (5th Floor, Building 2) 11 : 00~14 : 00

Useful information

Shopping

Maruzen Sophia Shop: Book, Stationery, Grocery (Basement, Building 2) 10 : 00~17 : 00

Convenience Store

Seven-Eleven (Basement, Building 6) 10 : 00~17 : 00

Computer and Internet Access

You can use a computer and free internet access Sep. 25-29, 11:00-14:00 (Room 310, 3rd Floor, Building 2)

REGISTERED Member only

Photocopy

You can photocopy - 10yen per copy (3rd Floor, Building 2 or in front of Maruzen in Basement, Building 2)

Public Telephone

Located near the Building 7

ATM Machines: Located in Seven-Eleven (Basement, Building 6)

Bank and Currency exchange

Mitsui Sumitomo Bank, Mizuho Bank and Tokyo-Mitsubishi UFJ Bank are located just across the Route 20.

Places near the Campus

The Post Office is located near the south gate.

Atre Yotsuya, a small shopping mall at Yostuya Station, has various restaurants such as Paul (Bakery and Cafe), Cocoro (Japanese Restaurant), and Noodle Bar (Thai Restaurant).

Siddique (Indian and Pakistan restaurant) is located near the east gate.(2 mins away from the east gate, along the Shinjuku Street)

Emergency

Health Center (2nd Floor, Hoffmann Hall)

Notice

We will record some of sessions by video or audio means. The use of them over the internet shall be based on separate agreement with the presenter.

Information Desk (Building 4, 1st Floor, Room 175) : Tel 080-7036-4938

Organizing Committee:

TANAKA Yutaka (Sophia University, Chair of the Organizing Committee)
NOBUHARA Tokiyuki (Keiwa-Gakuen University, Emeritus, Director of IPN)
HANAOKA Eiko (Osaka Prefecture University, Emeritus, Chief Editor of Proceedings)
MIYAMOTO Hisao, O.P. (Sophia University, Director of Sapientia Convivendi, Faculty of Theology)
KITO Hiroshi (Sophia University, Director of the Institute for Environmental Studies)
NAGAMACHI Yuji, S.J. (Sophia University) Joseph PUTTENKALAM, S.J. (Sophia University)
SUZUKI Nobukuni S.J. (Sophia University) Veliath CYRIL, S.J. (Sophia University)
KOO Mark chung-mo, S.J. (Sophia University) ITABASHI Yujin (Rissho University)
MURATA Haruo (Aomori Public University, St. Andrew University, Emeritus)
HHIROSE Chuichiro (Director of the Japan Society for Environmental Management)
NAKAMURA Noboru (Chuo University, Managing Director of JSPS)
HONGO Hitoshi (Tokyo-Denki University, Financial Director) HAGAO Shiro (Meiji University)
ITOW Shigeyuki (Kyushu Sangyo University)

Editorial Board

HANAOKA Eiko (Osaka Prefecture University, Emeritus, Chief Editor of Proceedings)
TANAKA Yutaka (Sophia University, Chair of the Organizing Committee)
TAKEDA Ryusei (Ryukoku University, Emeritus) ENDO Hiroshi (Waseda University, Emeritus)
MURATA Haruo (Aomori Public University, St. Andrew University, Emeritus)
ARAKAWA Yoshihiro (Tenri University) Itabash Yujin i (Rissho University)
HIRATA Ichiro (Kansai Gaidai University) TANIGUCHI Teruzou (St. Andrew University)
TAGUCHI Shigeru (Yamagata University) MURATA Yasuto (Nagoya Ryujo Junior College)
FUJINUMA Tsukasa (Aichi Sangyo University)

Organizing Staff

YOSHIDA Koji (Sophia University) HAYAKAWA Seisuke (Sophia University)
SARODO Shigeki (Sophia University) UMEDA Kota (Sophia University) KURIHARA Shiori (Sophia University)
ISHII Samoa (Sophia University) YAMAURA Yuzo (Sophia University) TSUDA Yoshio (Sophia University)
SATO Yosuke (Chuo University) IIMORI Motoaki (Chuo University) MIYAZAKI Toyohito (Organizer of JSPS)
SHIOTANI Ken (Organizer of JSPS) SHIRAI Masato (Toyo University)
MINAMI Mayu (Sophia Sustainable Coffee Movement), MIURA Shuichi (Sophia Glee Club)
XION Yawein (Sophia University) GENG Yining (Sophia University)
LI Zhouxi (Sophia University) QIU Yue (Sophia University) CHENG Qian (St. Paul's University)
SUGAYA Kaori (Sophia University 100th Anniversary Office)
YASUDA Megumi (KNT)



*Sapientia
Convivendi*